

# b-grip™

Innovative camera belt holder



## I ISTRUZIONI D'USO

## E INSTRUCTIONS

## F INSTRUCTIONS

## D BEDIENUNGSANLEITUNG



Distribuito da Cptech srl  
Via Salvo d'Acquisto, 2 - Quarto Inferiore  
40057 Granarolo dell'Emilia - Bologna - ITALY  
Sales: sales@bgrip.com

[WWW.BGRIP.COM](http://WWW.BGRIP.COM)

## I ISTRUZIONI D'USO

Cptech srl ringrazia per aver scelto b-grip™.

Per utilizzare al meglio b-grip™ è opportuno leggere attentamente le seguenti istruzioni. b-grip™ è un'esclusiva Cptech. Meccaniche e funzionalità di b-grip™ sono tutelate da internazionale patent pending.

**Contenuto della confezione**  
I b-grip™  
II b-belt  
III Manuale d'uso

### Componenti

- A Base
- B Piastra mobile
- C Vite universale
- D Braccetto rotante
- E Anello di sicurezza
- F Asola cintura
- G Leva di bloccaggio
- H Sicura addizionale

### Funzionamento

- 1 Ruotare la leva **G**
- 2 Arretrare la piastra **B**
- 3 Estrarre la piastra **B**
- 4 Infilare la cintura nelle sedi **F**
- 5 Indossare la b-belt e chiudere la fibbia

- 6 Assicurare la b-belt tramite l'asola di sicurezza
- 7 Fissare la piastra **B** alla fotocamera tramite la vite **C**
- 8 Stringere la vite **C** con una moneta, inserire lo stopper di gomma
- 9 Sollevare la leva **G**, agganciare la fotocamera e rilasciare la leva **G**
- 10 Posizionamento consigliato
- 11 Per una rapida sostituzione delle ottiche fissare la fotocamera con l'obiettivo verso l'alto e procedere alla sostituzione. Cptech raccomanda di sostituire le ottiche in ambienti incontaminati dal polvere sospese per preservare pulito il sensore della fotocamera
- 12 Estrarre il braccetto **D** per appoggiare la fotocamera su qualunque piano, si eviterà così il contatto delle ottiche con superfici sporche o abrasive

## E INSTRUCTIONS

Thank you for choosing the b-grip™.

To get the best performance from your b-grip™, please read the following instructions carefully. b-grip™ is an international patent pending product made in Italy by Cptech.

**Contents**  
I b-grip™ Holster with Quick-Release Plate

- II Adjustable Belt
- III Instruction Manual

### Components

- A Base
- B Quick-Release Plate
- C Universal Screw
- D Flip-Out Platform
- E Safety Connector Attachment Ring
- F Belt Loop
- G Locking Lever
- H Additional safety lock

### How it works

- 1 Rotate lever **G**
- 2 Pull back plate **B**
- 3 Remove plate **B**

## F INSTRUCTIONS

Merci d'avoir choisi le support b-grip™.

Pour obtenir le rendement optimum de votre b-grip™, veuillez lire attentivement les instructions suivantes. b-grip™ est un produit en instance de brevet international fabriqué en Italie par Cptech.

**Contenu**  
I Support b-grip™ avec plaque à dégagement rapide  
II Ceinture ajustable  
III Mode d'emploi

### Composantes

- A Base
- B Plaque à dégagement rapide
- C Vis universelle
- D Plate-forme pliante
- E Crochet de sécurité
- F Fente pour la ceinture
- G Levier de blocage
- H Levier supplémentaire de sécurité

### Fonctionnement

- 1 Faire tourner le levier **G**
- 2 Tirer sur la plaque **B**
- 3 Retirer la plaque **B**
- 4 Insérer la ceinture dans les passants **F**

## D BEDIENUNGSANLEITUNG

Vielen Dank, dass Sie sich für den Kauf des b-grip™ von CP Tech entschieden haben.

Um dem b-grip™ optimal zu nutzen, empfehlen wir Ihnen, diese Anweisungen sorgfältig zu lesen, und den Anweisungen zu folgen. Der b-grip™ von Cptech ist ein zum Patent angemeldetes Produkt und somit vor Nachahmung geschützt.

### Inhalt

- I b-grip™
- II b-belt Gürtel
- III Bedienungsanleitung

### Einzelteile

- A Basis
- B Wechselplatte
- C 1/4 Zoll Schraube
- D Verstellbare Platte
- E Sicherheitsring
- F Gürtelhalterung
- G Trigger Sperrn / Entsperrn
- H zusätzliche Sicherheit Hebel

### Anleitung

- 1 Öffnen Sie die Arretierungshebel **G**
- 2 Ziehen Sie die Fixierung zurück **B**
- 3 Entfernen Sie die Schnellwechselplatte
- 4 Ziehen Sie den Gurt durch die Schlaufen
- 5 Führen Sie den Gürtel in die Schnalle und verschließen diese.

- 5 Insérer la ceinture sous la boucle et la verrouiller en place
- 6 Passer l'excédent de la ceinture dans les guides
- 7 Fixer la plaque **B** à l'appareil-photo à l'aide de la vis **C**
- 8 (no description, image only)
- 9 Tourner le levier **G**, fixer l'appareil-photo, relâcher le levier **G**
- 10 Position recommandée
- 11 Pour changer rapidement et facilement l'objectif, mettre l'appareil-photo en position renversée. CPTech recommande de changer l'objectif à des endroits où l'air est propre afin que le capteur de l'appareil-photo reste propre
- 12 Utiliser la plateforme **D** pliante pour table qui permet d'éviter tout contact direct de l'objectif avec des surfaces sales ou abrasives et de maintenir l'appareil stable

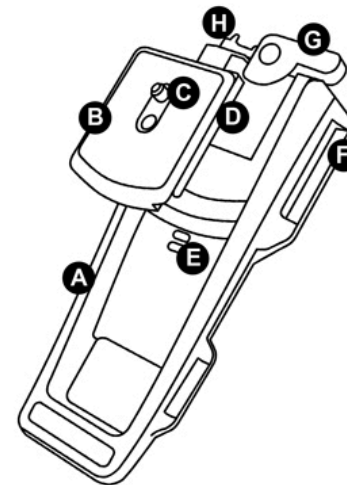
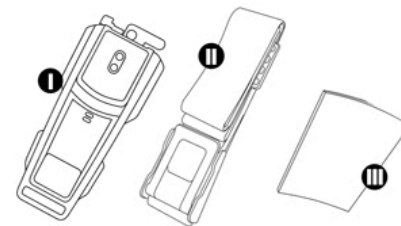

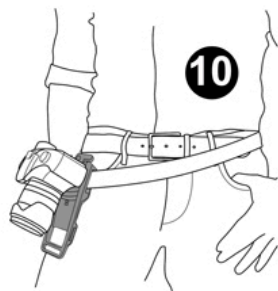
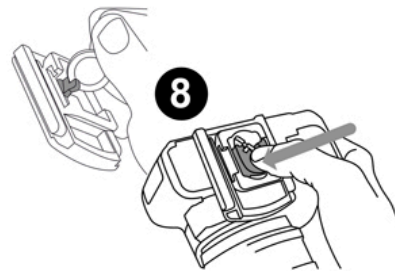
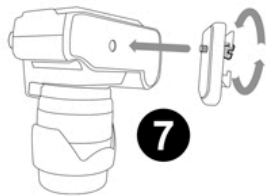
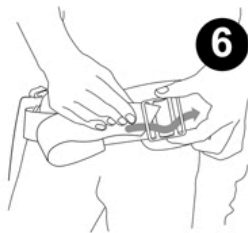
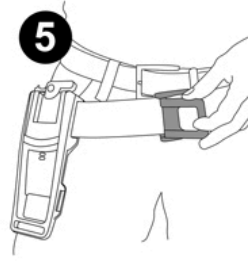
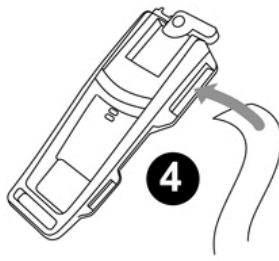
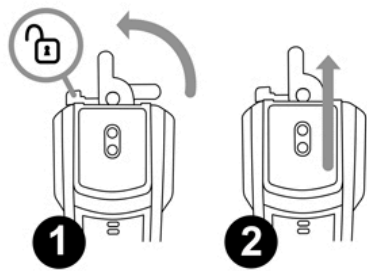

Accessory line (optional):

**b-grip**  
travel kit



Support for backpack attachment plus waterproof cover. Perfect for trekking and outdoor activities

**Additional warnings**

- This b-grip kit is the basic "ready to shoot", the travel kit (waterproof cover and backpack adapter) are optional accessories not included in this package.
- All CPtech products have been produced with care and 100% quality control has been applied. During product development stage all the products and used materials have been exposed to usage and chemical tests and their performance has been evaluated to ensure high customer satisfaction.
- The warranty offered for this CPtech product is Lifetime Limited Warranty unless otherwise stated on the packaging of the product. We warrant that all of the products are free from defects in material and in workmanship.
- The warranty does not apply to damage caused by abnormal or unreasonable use, use beyond the product's intended purpose, tampering, alterations, unauthorized product repairs, neglect, accidents, abrasion, exposure to extreme temperatures, solvents, acids, normal wasting for long usage and tear damage.
- CPtech's warranty applies only to CPtech products and it does not apply to any non-CPtech product, even if packaged or sold with it. This warranty specifically excludes any kind of damages to items stored or carried in CPtech products.
- We recommend that you treat all b-grip parts with care. Exposure to direct heat and sunlight might cause slight changes in appearance. Do not use any chemical cleaners to care for this product and do avoid its direct contact with chemicals and damp/wet surfaces. Contact with chemicals might cause damages on the material. To maintain the beauty of your b-grip you can clean it with water and soap, than dry it.
- Occasionally a light lubrication of the locking lever should be needed.
- During long usage we recommend to periodically check the correct tightening of the universal screw.
- You don't need to do anything to activate the warranty. By the time you purchase a CPtech product the warranty starts.
- If you see any defect at the material or workmanship at the time of purchase or if you experience any problem with the product while using it, please contact us through the "Contact Page" at [www.bgrip.com](http://www.bgrip.com) link and state your product's model name, colour, defect's description, your location and contact details.